

English



**Installation Instructions -
For Service Persons Only**

Model No: RX1-150 **Revision 2022**

Product Description

1 Channel Receiver: 150m Code Hopping

Features

- Code-Hopping Encryption; 1 x Relay output
- Normally Open / Closed; ABS housing
- Frequency stability controlled +/- 75KHz



Technical Specifications:

Model:	RX1-150
Encryption type:	Code hopping
Transmission frequency:	403MHz (Local) 433MHz (Export)
Transmission method:	OOK
Modulation:	AM
Transmission range:	150m "Line of sight" 60m "Indoors"
Memory capacity:	80 remotes
Voltage range:	10VDC to 24VDC
Standby current consumption:	+/-14mA 10%
Current consumption all on:	+/-50mA 10%
Operating Temperature:	-7°C to 49°C
Dimension (lxbxh)	100 x 60 x 25mm
Gross weight:	78g Packed

Warranty

This product is sold subject to our standard warranty conditions and is warrantied against defects in workmanship for a period of 2 years.

Customer Support line: +2711 462 5101 | E-mail: technical@sherlotronics.co.za

Wiring

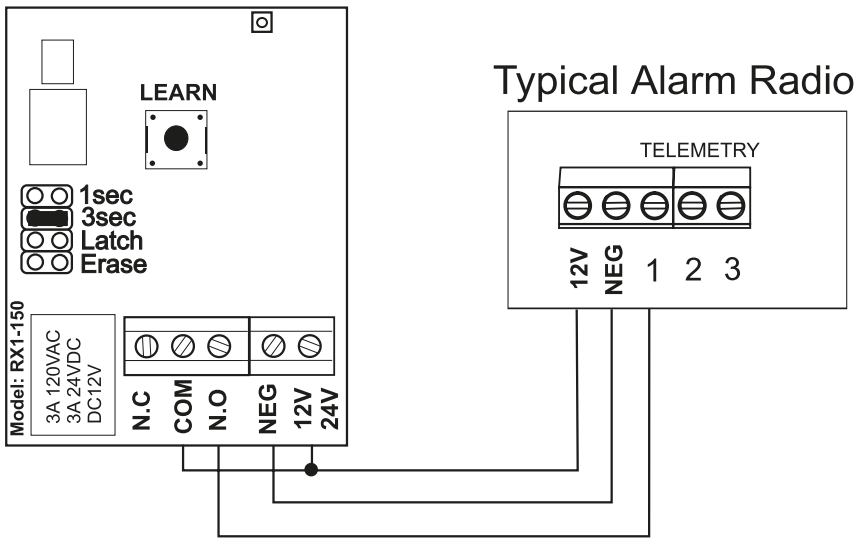
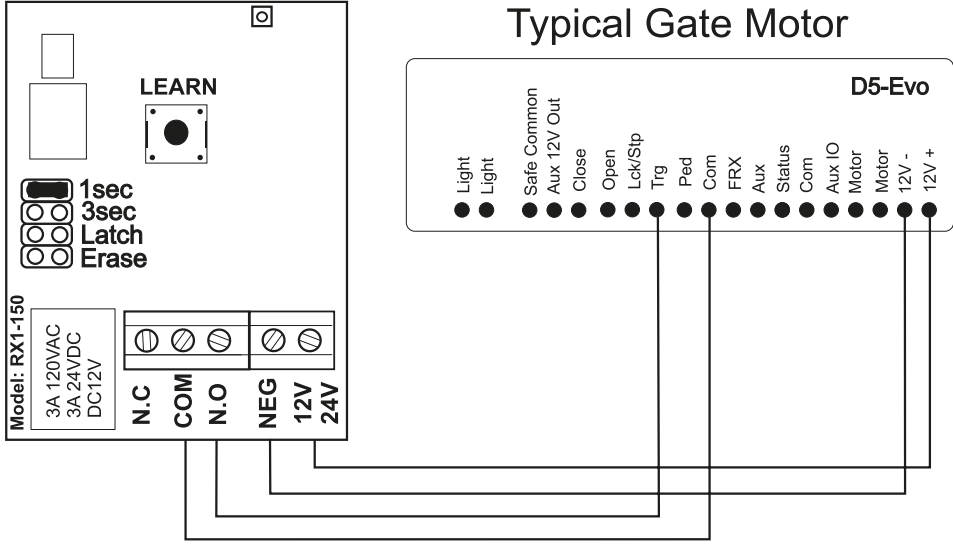

Relay time jumper settings

<p>0.5 Second</p> <p>Gate & garage door automation</p>	<p>1 Second</p> <p>Gate & garage door automation</p>	<p>3 Seconds</p> <p>Panic on alarm panel</p>	<p>30 Seconds</p> <p>Maglock release</p>
<p>1 Minute</p> <p>Beam / Zone bypass</p>	<p>3 Minutes</p> <p>Siren output or beam bypass</p>	<p>On / Off</p> <p>Code 1 = ON Code 2 = OFF</p>	<p>Latch & Unlatch</p> <p>Arming & Disarming alarm panels</p>

Programming remotes in

1. Default the unit before you begin a new installation.
This erases all previously programmed remotes.
2. Press the LEARN switch once. (1 x beep sounds)
3. Press the button on the remote control 2 times to learn the code to the receiver. (2x short beeps & 1 x Long beep)

The unit exits from program mode when a new remote is learnt.
This helps prevent the unit from learning in stray signals

4. Continue with step 2 to 3 to learn additional new remotes



NOTE:

Note: The unit can be programmed with up to 80 remotes. When the memory limit has reached its limit the RX1-150 will auto exit out of program mode. The unit auto exits out of program mode if Nothing is received after 30 seconds.

Erasing individual remotes

1. Link the ERASE jumper
2. Press the LEARN switch
3. Press the remote to be erased
4. Repeat step 2 & 3 for each remote to be erased.
5. Remove ERASE jumper when done

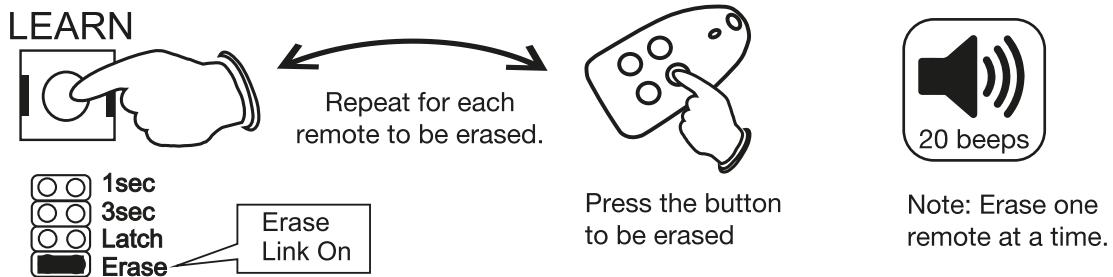

Programming the ON/OFF function

1. Default the unit before you begin a new installation.
This erases all previously programmed remotes.
2. Select the 1 sec & 3 sec relay time jumpers respectively.
3. Press the LEARN switch once. (ON = 1 x beep)
4. Press the button on the remote control for the ON command. (2 x short beeps sound when the remote is learnt in)
5. Press the LEARN switch again to advance to the OFF command (2 x short beeps sounds)
6. Press the button on the remote control for the OFF command. (2 x short beeps sound when the remote is learnt in)
7. Press the LEARN switch again to exit out of learn mode (1 x long beep sounds)

Defaulting the UNIT

Note: Please default the unit first before doing a brand new installation. This will erase any previously programmed factory test remotes from the memory.

Press and hold for more than 10 Seconds.
When the beeping stops the unit is defaulted.
Wait a few seconds until it re-boots.





What to do if you suspect your remote is false triggering

If you have experienced the strange phenomena of finding your gate or garage door been open sometime in the middle of the night and suspect that it may be the remote control false triggering, please follow the below steps to identify what the cause may be. This will help solve the mystery and prevent any further disruptions.

Step 1: Open up all the remote controls, as in unscrew the housings and remove the board completely out the housing. Once you have done this, carefully inspect each remote board making sure that you do not have any moisture / water / corrosion / loose parts, broken / sticky or collapsed buttons. Also check for heavy wear and tear on the casing as the remote may have been stood on or dropped from a height and could be cracked.

Step 2: Open the housing of the remote control's receiver device. This is the device that is connected to the gate or garage door motor. This device receives the signals from the remote control and is usually a small black box with a wire antennae or a larger white box with a screw-on whip antennae. Once you have opened the receiver device, check for any moisture on the board, ants nesting, damaged components or loose wires. Also please check if the board has a QC date code label. If your receiver is more than 7 years old, please look at upgrading the device as it may have components that are not working correctly anymore.

Step 3: Open the Gate or Garage door motor housing and inspect the electronic board making sure that no insects are nesting on the board, moisture or water is present and that the board is clean dust free and looks undamaged.

Step 4: Default the Receiver. Please follow the applicable Defaulting instructions according to the model receiver you have installed. In most instances you need to remove all the jumpers off the board and press and hold the LEARN button down for 20 seconds. For models older than 5 years, revert to the manual.

Step 5: Relearn in the Remote controls making sure that they were inspected first on Step 1. Also do this part carefully making sure that no stray signals from other remotes are accidentally learnt in. Once you have followed all the steps above, monitor your system. If you experience further problems, please contact us for advice.

Certifications

ETSI EN300 220-V2.4.1
ETSI EN301-489-3 V1.4.1
ETSI EN301-489-1 V1.9.2
IEC 60950-1:2005 + A1:2009
ICASA TA-2017/1846

Order Codes:

1 Channel Receiver:
150m Code-hopping
RX1-150



Model No: **RX1-150**

Manufactured between 2016-2021

1 Channel Receiver : 150m Code Hopping

Technical Specifications:

Model:	RX1-150
Encryption type:	Code hopping
Transmission frequency:	403MHz (Local) 433MHz(Export)
Transmission method:	OOK
Modulation	AM
Transmission range:	150m "Line of sight" 60m "Indoors"
Memory capacity:	80 remotes
Voltage range:	10VDC to 16VDC
Standby current consumption:	+/-14mA 10%
Current consumption all on:	+/-50mA 10%
Operating Temperature:	-3°C to 49°C
Dimension (lxbxh)	100 x 60 x 25mm
Gross weight:	78g Packed

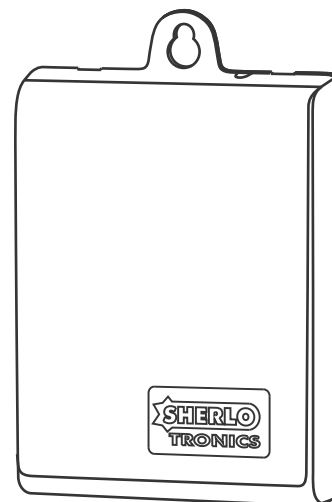

Features:

Code-Hopping Encryption

1 x Relay output

Normally Open / Closed

ABS housing

Frequency stability controlled +/- 75KHz

Approvals:

This product is approved for use in residential, commercial and light Industrial environment and complies with the essential protection requirements of the R&TTE Directive 1999/EC on the approximation of the laws of the Member states relating to electromagnetic compatibility and radio spectrum.

Certifications:

- ETSI EN300 220-V2.4.1
- ETSI EN301-489-3 V1.4.1
- ETSI EN301-489-1 V1.9.2
- IEC 60950-1:2005 + A1:2009



Order Codes:

1 Channel Receiver : 150m Code-hopping **RX1-150**

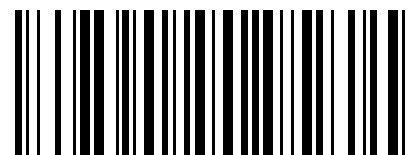
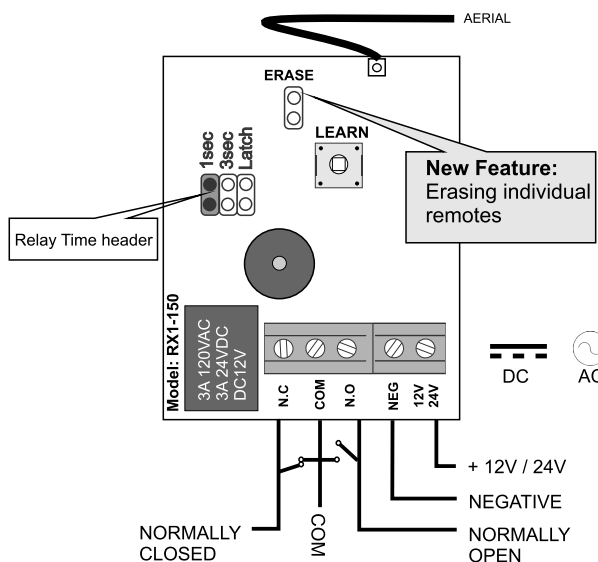

RX1 - 150

Defaulting the UNIT

Note: Please default the unit first before installation. This will erase any previously programmed factory test remotes from the memory.

Press and hold for more than 10 Seconds. When the beeping stops the unit is defaulted. Wait a few seconds until it re-boots.



Programming remotes in

1. Default the unit before you begin a new installation. This erases all previously programmed remotes.
2. Press the LEARN switch once to step to relay 1. (1 x beep sounds)
3. Press the button on the remote control a few times to learn in to the receiver. (2x beeps sound)
4. Continue to learn in any additional remote controls until all the remotes are programmed in.
5. Press the LEARN switch again to Exit out of learn mode. (1 x Long beep sounds)

Note: The unit can be programmed with up to 80 remotes. When the memory limit has reached its limit the RX1-150 will auto exit out of program mode. The unit auto exits out of program mode if nothing is received after 10 -20 seconds.

Programming the ON/OFF function

1. Default the unit before you begin a new installation. This erases all previously programmed remotes.
2. Select the 1 sec & 3 sec relay time jumpers respectively.
3. Press the LEARN switch once to step to relay 1 (ON command) (1 x beep sounds)
4. Press the button on the remote control for the ON command. (2 x short beeps sound)
5. Press the LEARN switch again to advance to the OFF command. (2 x beep sounds)
6. Press the button on the remote control for the OFF command. (2 x short beeps sound)
7. Press the LEARN switch again to exit out of learn mode (1 x long beep sounds)

Erasing individual remotes

1. Link the ERASE jumper
2. Press the LEARN switch
3. Press the remote to be erased
4. Repeat step 2 & 3 for each remote to be erased.
5. Remove ERASE jumper when done

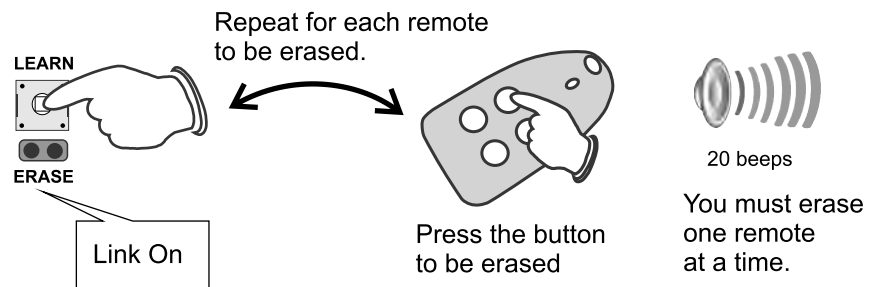

Relay time jumper settings

0.5 Second



Garage door automation

1 Second

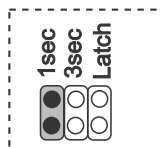

Gate & garage door automation

3 Seconds

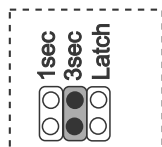

Panic on alarm panel

Latch & Unlatch

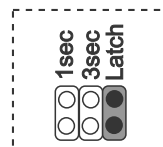

Arming & Disarming alarm panels

3 Minute

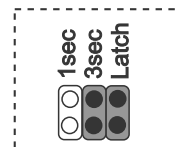

Siren output or beam bypass

On / Off

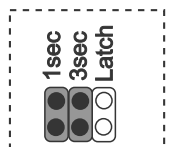

Code 1 = ON
Code 2 = OFF

Warranty

This product is sold subject to our standard warranty conditions and is warranted against defects in workmanship for a period of two years.

Customer Support line: +2711 462 5101 E-mail: technical@sherlotronics.co.za